

## Valvole rotative LDR\_ - Rotary valves LDR\_

### A passaggio verticale 1bar - Drop-thru 1bar

- Alta efficienza di riempimento  
*High filling efficiency*
- Minime perdite di trafilamento  
*Minimum gas leakage*
- Costruzione robusta  
*Heavy duty construction*
- Cuscinetti esterni e tenute flussate  
*Outboard bearings and air purge type seals*
- Flange secondo DIN PN10 o ANSI 150  
*Flanges in accordance with DIN PN10 or ANSI 150*
- Versioni antideflagranti fino a 10 bar per polveri St2  
*Explosion proof versions up to 10 bar and St2 products*
- Versioni certificate ATEX 2014/34/EU  
*Versions in accordance with ATEX 2014/34/EU*
- Disponibili versioni a smontaggio rapido  
*Fast opening versions available*



**Applicazione**  
*Application*

Alimentatori di materiali in polvere in sistemi di trasporto pneumatico o scaricatori e dosatori sottosili e tramogge. Ampia gamma di versioni ed accessori disponibili.

*Volumetric feeders for powders in pneumatic conveying systems or discharger and metering valves below silos and hoppers. Large range of versions and options available.*

**Dimensioni**  
*Size*

6, 8, 10, 12, 14  
da 4 a 52 Litri/giro

6, 8, 10, 12, 14  
4 to 52 Litres/rev.

**Pressione**  
*Pressure range*

Fino a 1bar di pressione differenziale

*Up to 1bar differential pressure*

**Temperatura**  
*Temperature*

Fino a 40°C (Versioni standard)  
Versioni per alte temperature fino a 350°C

*Up to 40°C (Standard versions)  
High temperature versions up to 350°C*

**Materiali di costruzione**  
*Construction materials*

- Corpo e coperchi  
Fusioni di ghisa, Acciaio inossidabile
- Rotore  
Acciaio al carbonio, acciaio inossidabile
- Estremità delle pale  
Acciaio antiusura, acciaio inossidabile
- Trattamenti superficiali interni  
Nichelatura chimica, cromatura dura, carburo di tungsteno, teflonatura

- *Body and end covers*  
*Cast iron, Cast stainless steel*
- *Rotor*  
*Carbon steel, stainless steel*
- *Replaceable blade tips*  
*Hardened steel, stainless steel*
- *Internal surface treatments*  
*Nickel-plating, hard chrome-plating, tungsten carbide, teflon*

## Valvole rotative LDR\_ - Rotary valves LDR\_

### Caratteristiche - Design features

**Trasmissione diretta o a catena**  
*Direct drive or chain drive*

**Basse perdite di trafilamento e alta efficienza di riempimento**  
grazie ai minimi giochi interni  
**Minimal gas leakage loss and greater filling efficiency**  
*due to tight internal clearances*

**Ampi fori di sfiato integrati (Opzionale)**  
**Body vent openings integrated into housing (Optional)**

**Rotori aperti con 10 pale**  
**10 vanes Open end rotor**

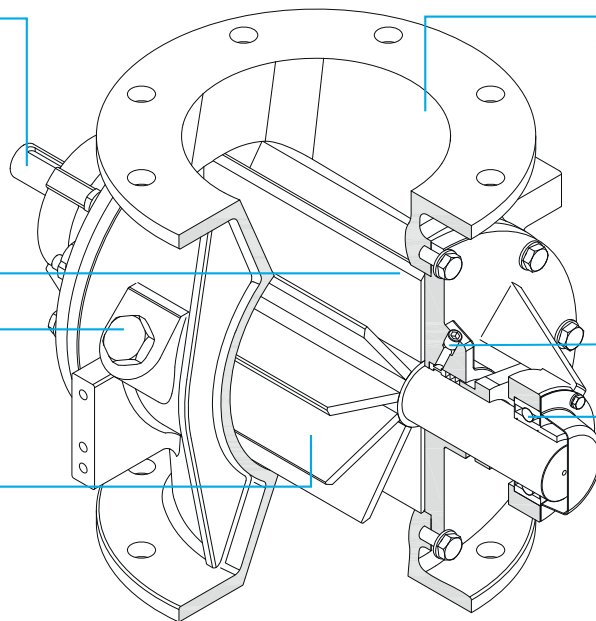

**Robusto corpo in fusione**  
con entrata ed uscita tonde di grandi dimensioni  
**Rugged cast body**  
*with large round inlet and outlet*

**Tenuta flussata (Versione standard)**  
Ampia gamma di tenute disponibili a richiesta  
**Air purge type seal (Standard version)**  
*Large range of shaft sealing are available on request*

**Cuscinetti montati esternamente,**  
separati dal prodotto tramite lo spazio esterno tra tenuta e cuscinetto  
**Outboard mounted ball bearings,**  
*separated from product by outlet space between shaft seal and bearing*

### Dati tecnici - Technical data

#### Diagrammi Diagrams

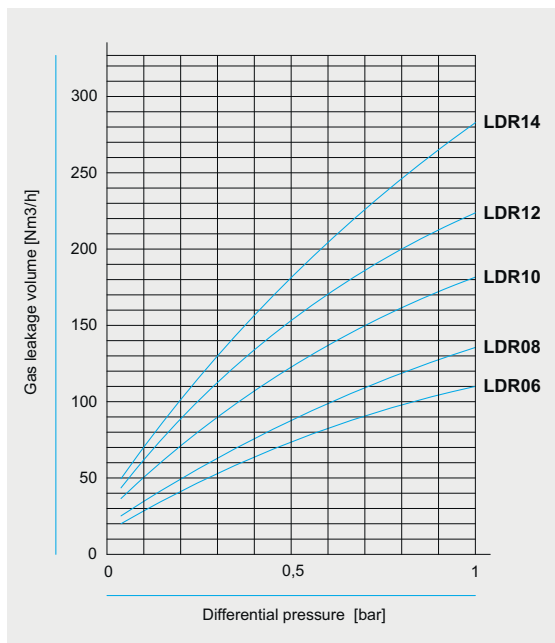

- Diagramma delle perdite di trafilamento**  
 (Valvole nuove con giochi standard, senza prodotto)  
**Gas leakage diagram**  
 (New valves with standard clearances, without product)

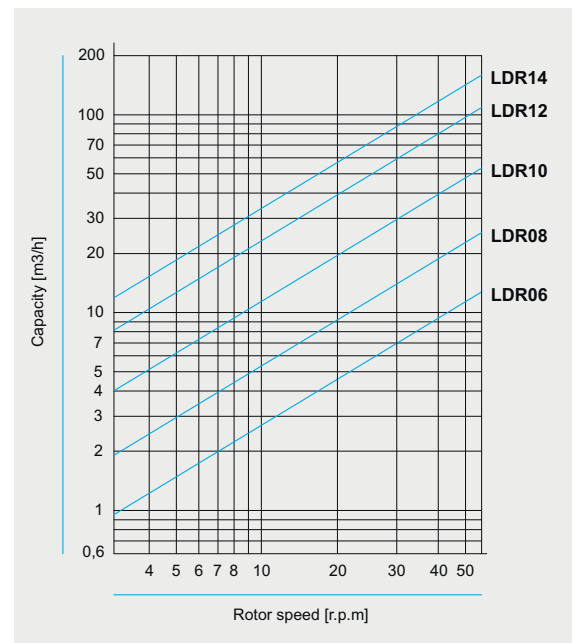

- Diagramma delle portate (Riempimento al 100%)**  
**Capacity diagram (Filling efficiency 100%)**

## Valvole rotative LDR\_ - Rotary valves LDR\_

### Versioni - Versions

#### Versioni Versions



- **Versioni ATEX 2014/34/EU**  
Gruppo II, Zona 1/21, Cat.2GD  
Gruppo II, Zona 0/20, Cat.1GD
- **Versions ATEX 2014/34/EU**  
Group II, Zone 1/21, Cat.2GD  
Group II, Zone 0/20, Cat.1GD

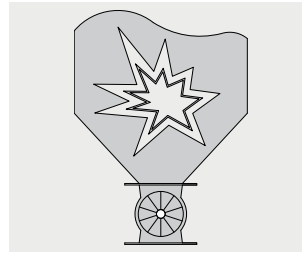

- **Versioni certificate EN15089**  
“Sistemi di isolamento dell’esplosione”, per polveri St1 e St2 e resistenti a sovrappressioni fino a 10bar
- **Versions conforming to EN15089**  
“Explosion isolation system”, for dusts St1 and St2 and pressure shock resistant up to 10bar

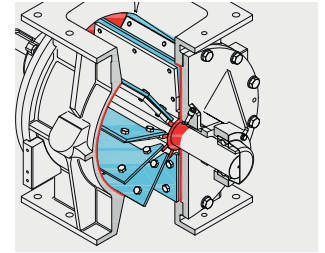

- **Versioni antiusura,**  
differenti soluzioni e materiali con più livelli di protezione
- **Wear resistance versions,**  
various designs and materials with different wear protection levels

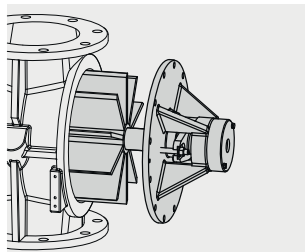

- **Versioni a smontaggio rapido**  
*Fast opening versions*

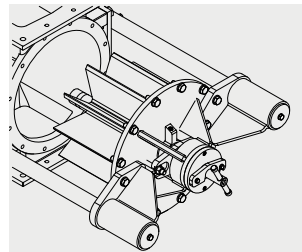

- **Versioni a smontaggio rapido con guide di estrazione**  
*Fast opening versions with supporting bars*

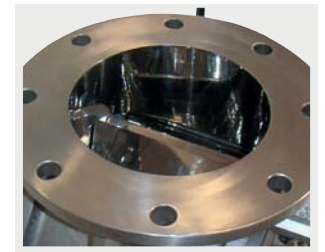

- **Versioni sanitarie:**  
Parti a contatto con il prodotto e vani del rotore raccordati e lucidati Ra<0,8 µm, pale smussate e tenuta albero conformi FDA
- **Sanitary versions:**  
*Product contact surfaces and rotor pockets radiused and polished Ra<0,8 µm, chamfered blades and shaft seal FDA conforming*

### Rotori - Rotors

#### Rotori Rotors

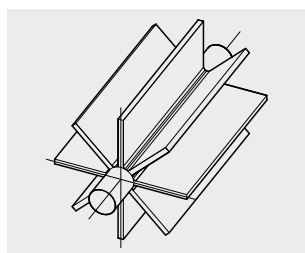

- **Rotore A**  
Rotore aperto  
**Rotor A**  
*Open end rotor*

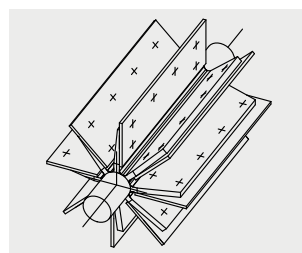

- **Rotore C**  
Rotore aperto con pale sostituibili  
**Rotor C**  
*Open end rotor with replaceable blades*

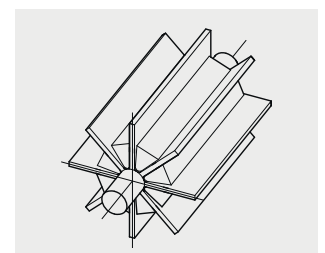

- **Rotori parzialmente riempiti**  
*Partially filled rotors*

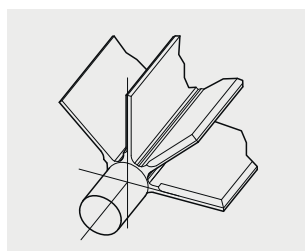

- **Rotori con pale smussate**  
*Rotors with beveled edge blades*

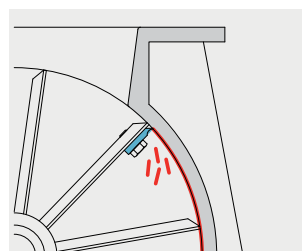

- **Rotori con raschiatori**  
*Scraper blades rotors*

## Valvole rotative LDR\_ - Rotary valves LDR\_

### Accessori - Accessories

Accessori  
Accessories

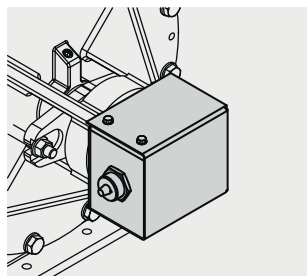

■ Controllo di rotazione  
*Motion indicator*

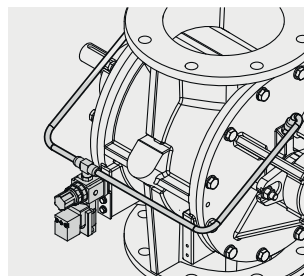

■ Sistema di flussaggio delle tenute  
*Shaft seals air purge system*

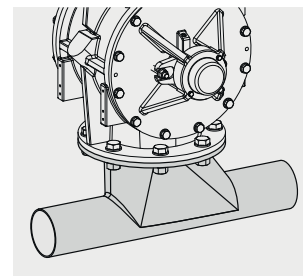

■ Iniettore per trasporti pneumatici  
*Pneumatic conveying manifold*

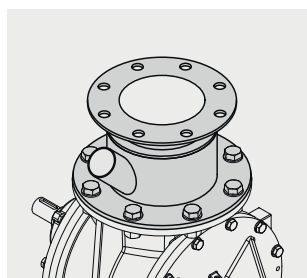

■ Sistema di sfiato AVS  
*Air vent system AVS*

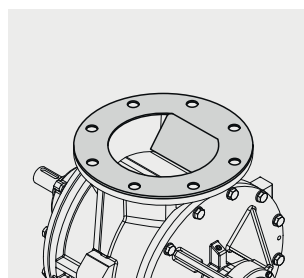

■ Entrata a deflettore  
*Inlet material deflector*

### Designazione del tipo - Type designation

Esempio  
Example

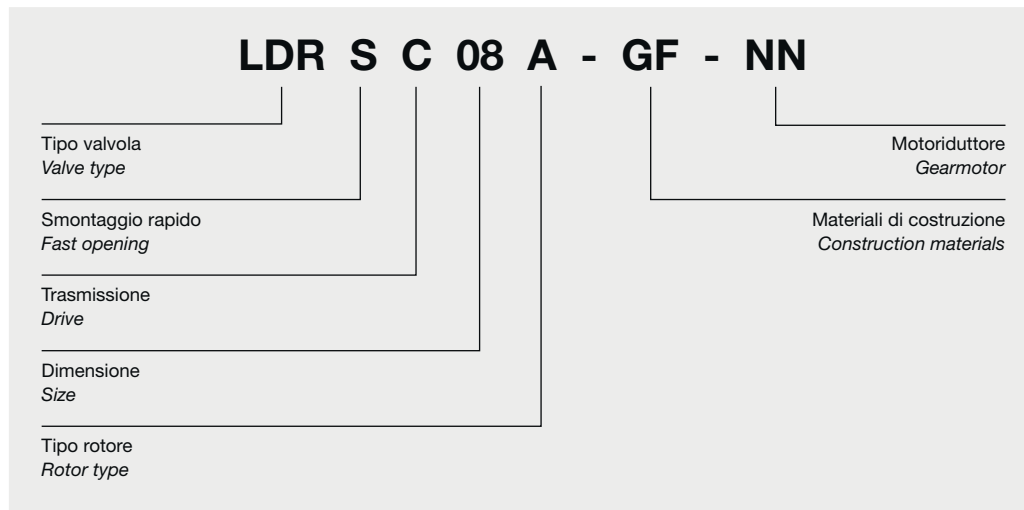

# Valvole rotative LDRM\_ - Rotary valves LDRM\_

## Dimensioni - Dimensions

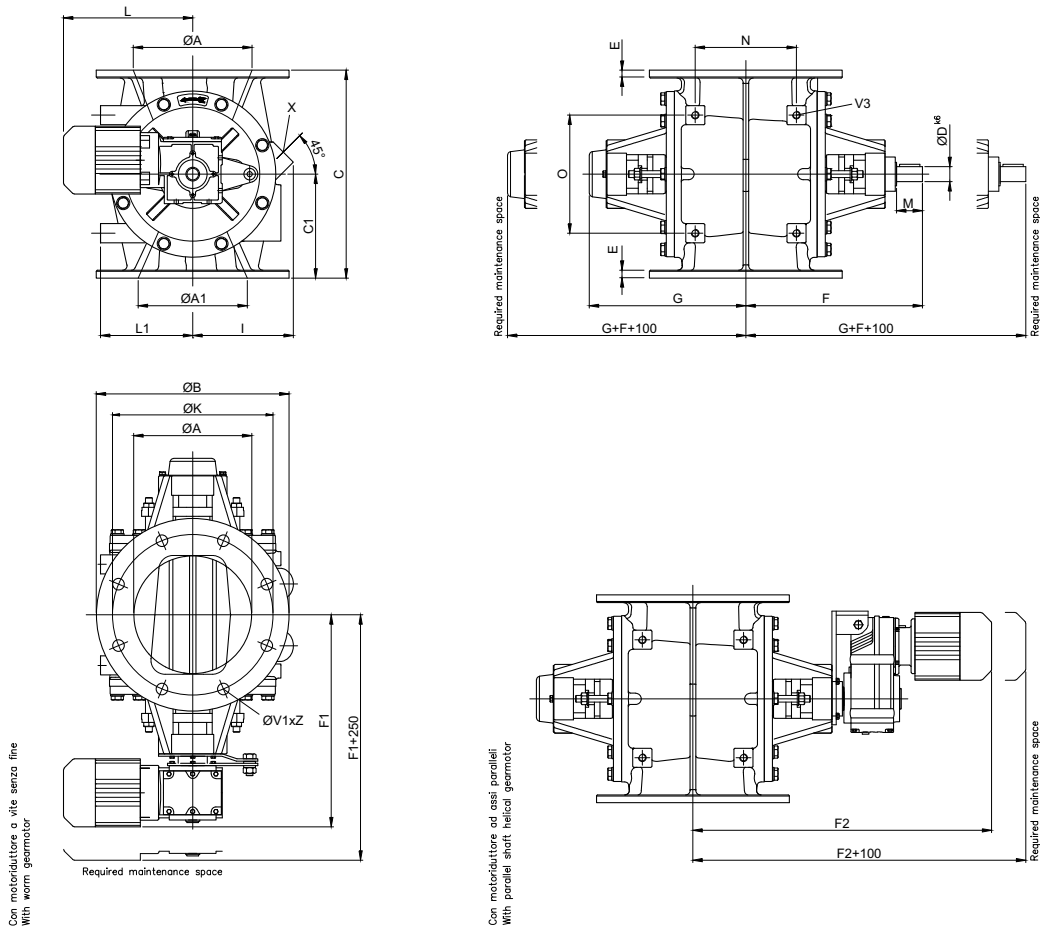

	Ltr/rev Ltr/giro	Ø A	Ø A1	Ø B	Ø K DIN	Ø K ANSI	C	C1	Ø D <sup>k6</sup>	E	F	F1 <sup>2)</sup>	F2 <sup>2)</sup>
<b>LDRM06</b>	4	160	152	285	240	241,3	300	150	25	12	310	390	540
<b>LDRM08</b>	7,5	210	203	343	295	298,4	370	185	30	14	333	440	605
<b>LDRM10</b>	17	265	252	406	350	361,9	450	225	35	16	370	---	660
<b>LDRM12</b>	33	316	302	483	400	431,8	540	270	35	18	400	---	730
<b>LDRM14</b>	52	360	350	530	460	476,2	610	305	40	20	441	---	785

	G	I	L <sup>2)</sup>	L1	M	N	O	Ø V1 x Z DIN	Ø V1 x Z ANSI	V3	X <sup>3)</sup>	Kg <sup>1)</sup>
<b>LDRM06</b>	255	135	315	124	60	172	162	22 x 8	22,2 x 8	M12	2 x G3/4"	95
<b>LDRM08</b>	280	170	323	160	60	180	210	22 x 8	22,2 x 8	M16	2 x G1"	130
<b>LDRM10</b>	305	212	---	194	70	261	280	22 x 12	25,4 x 12	M16	2 x G1"	180
<b>LDRM12</b>	335	264	---	236	70	304	320	22 x 12	25,4 x 12	M16	2 x G1-1/2"	275
<b>LDRM14</b>	375	290	---	267	70	360	340	22 x 16	28,6 x 12	M20	2 x G1-1/2"	365

1) Peso approssimativo / Weight approx.  
 2) Misure approssimative / Measurements approx.  
 3) Optional

## Valvole rotative LDRC\_ - Rotary valves LDRC\_

### Dimensioni - Dimensions

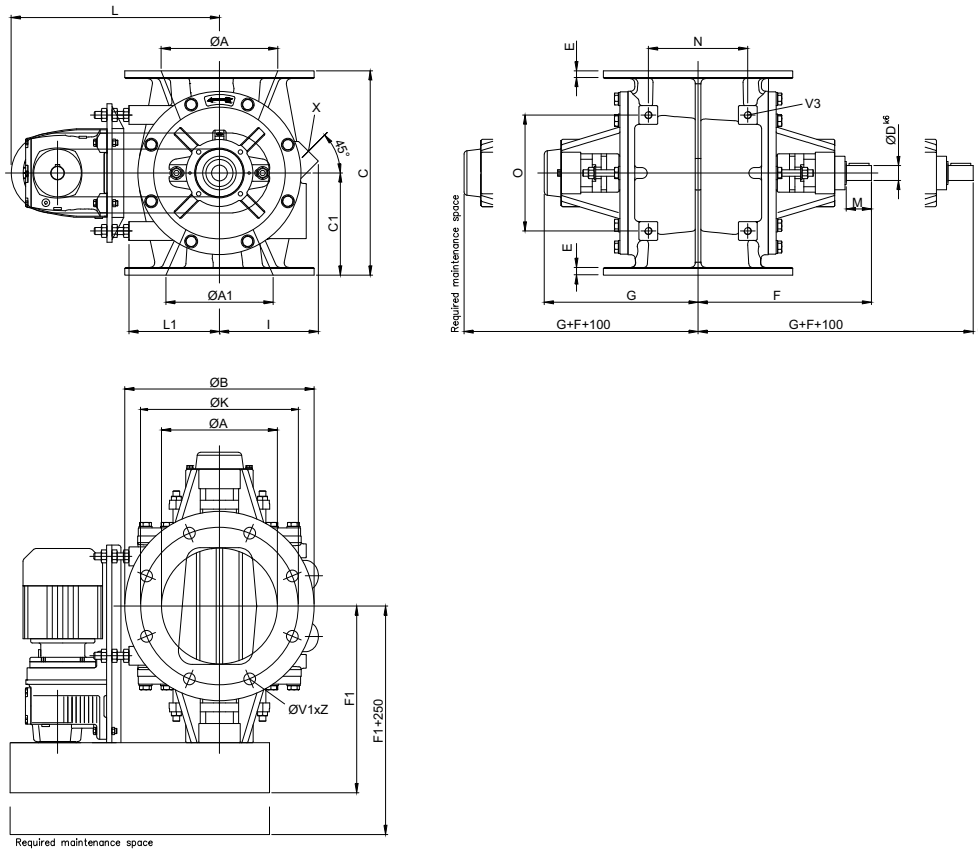

	Ltr/rev Ltr/giro	Ø A	Ø A1	Ø B	Ø K DIN	Ø K ANSI	C	C1	Ø D <sup>K6</sup>	E	F	F1
<b>LDRC06</b>	4	160	152	285	240	241,3	300	150	25	12	310	326
<b>LDRC08</b>	7,5	210	203	343	295	298,4	370	185	30	14	333	348
<b>LDRC10</b>	17	265	252	406	350	361,9	450	225	35	16	370	374
<b>LDRC12</b>	33	316	302	483	400	431,8	540	270	35	18	400	404
<b>LDRC14</b>	52	360	350	530	460	476,2	610	305	40	20	441	438

	G	I	L <sup>2)</sup>	L1	M	N	O	Ø V1 x Z DIN	Ø V1 x Z ANSI	V3	X <sup>3)</sup>	Kg <sup>1)</sup>
<b>LDRC06</b>	255	135	375	124	60	172	162	22 x 8	22,2 x 8	M12	2 x G3/4"	95
<b>LDRC08</b>	280	170	445	160	60	180	210	22 x 8	22,2 x 8	M16	2 x G1"	135
<b>LDRC10</b>	305	212	445	194	70	261	280	22 x 12	25,4 x 12	M16	2 x G1"	190
<b>LDRC12</b>	335	264	522	236	70	304	320	22 x 12	25,4 x 12	M16	2 x G1-1/2"	295
<b>LDRC14</b>	375	290	590	267	70	360	340	22 x 16	28,6 x 12	M20	2 x G1-1/2"	375

1) Peso approssimativo / Weight approx.  
 2) Misure approssimative / Measurements approx.  
 3) Optional

## Válvulas Rotativas Italianas



**LDC\_**  
Valvole rotative – 0,1 bar  
*Rotary valves – 0,1 bar*



**DC\_**  
Valvole rotative – 0,1 bar  
*Rotary valves – 0,1 bar*



**LDT\_**  
Valvole rotative – 1 bar  
*Rotary valves – 1 bar*



**LBT\_**  
Valvole rotative a flusso attraversato – 1 bar  
*Blow-thru Rotary valves – 1 bar*



**LSE\_**  
Valvole rotative per granuli – 1 bar  
*Rotary valves for pellets – 1 bar*



Versioni a smontaggio rapido  
*Fast opening versions*



Versioni con guide di estrazione  
*Versions with supporting bars*

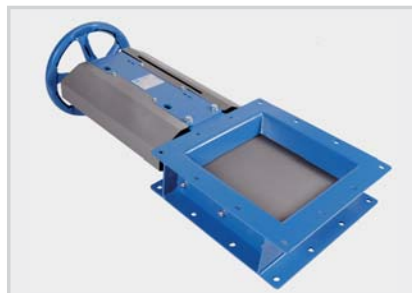

**VP\_, VPH\_**  
Valvole a ghigliottina  
*Slides Valves*



**SA\_**  
Valvole a doppio clapet  
*Double flap gate valves*

